

Point 14
81

- INST --
 1 - ATT Installed Anchor
 1 - Joint Pole - AT&T Custodian - 35' Class 3
 1 - Guy Ins 36IN and Mtng Plate
 1 - Anchor Guy 10M
 1 - Secondary Clamp

- REMOV --
 1 - Remove Pole Framing - Cut Pole Top After Shifting

- TRAN --
 1 - Shift Open Wire Secondary
 1 - Shift Street Light

Point 12
80

- INST --
 1 - Joint Pole - AT&T Custodian - 35' Class 3
 1 - Secondary Clamp

- REMOV --
 1 - Remove Pole Framing - Cut Pole Top After Shifting

- TRAN --
 1 - Shift Open Wire Secondary
 1 - Shift Street Light

Note: Wire Work in this WR Includes Installation of New Primary Within WR# 1080127 Also

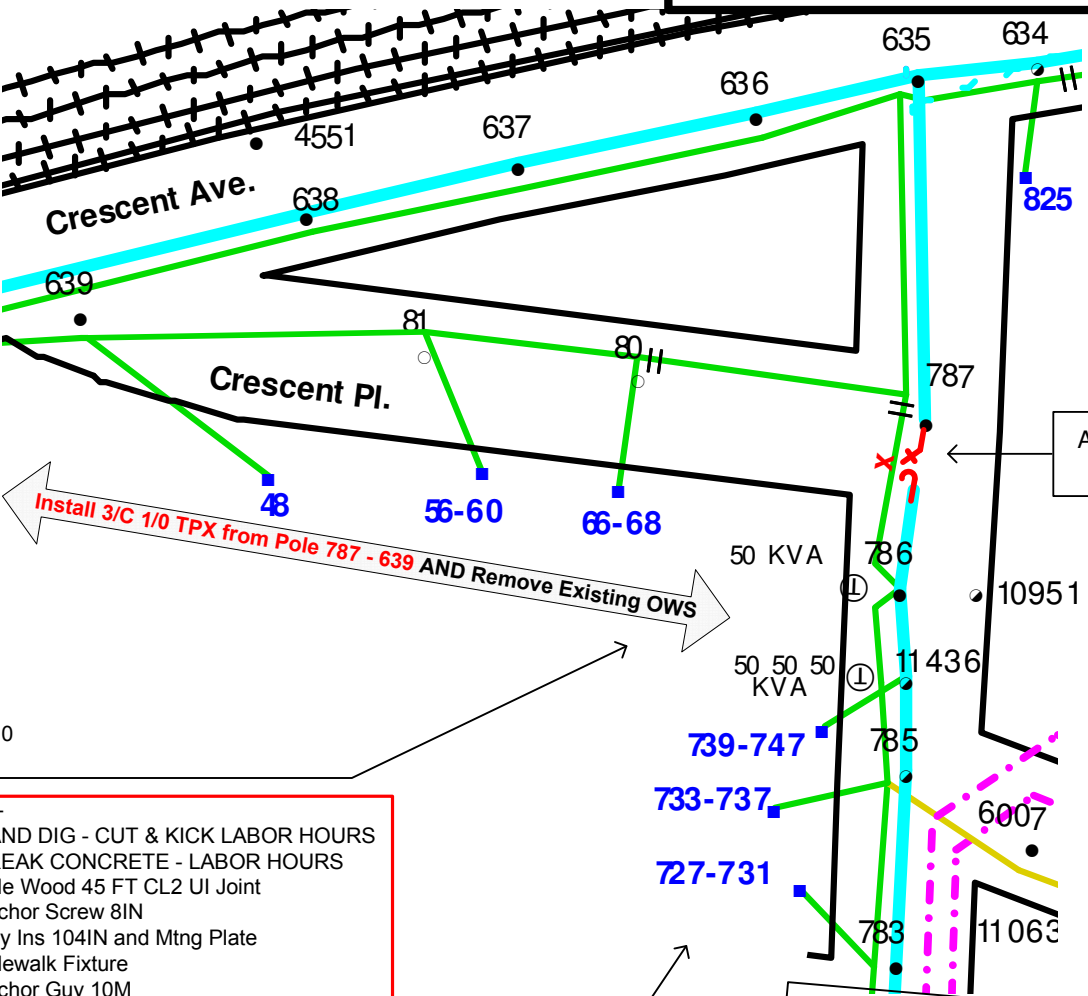

Install Three 397.5 AL Primary from pole 635 - 783 AND Remove Copper Primary

Install 3/C 1/0 TPX from Pole 787 - 783 AND Remove Existing OWS

Point 10
787

- INST --
 5 - HAND DIG - CUT & KICK LABOR HOURS
 6 - BREAK CONCRETE - LABOR HOURS
 1 - Pole Wood 45 FT CL2 UI Joint
 1 - Anchor Screw 8IN
 1 - Guy Ins 104IN and Mtng Plate
 1 - Sidewalk Fixture
 1 - Anchor Guy 10M
 1 - Pole Top Pin 24 in.
 1 - Double 10 Ft Crossarms
 5 - High Voltage Insulator and F Neck Tie
 3 - Floating Insulator
 1 - Break 1/0 Alum. Secondary(s)
 3 - Air Break SW 600 amp
 1 - Driven Ground

- REMOV --
 1 - Remove Pole Framing - Cut Pole Top

- TRAN --
 1 - Shift 3 Primary
 2 - Shift Open Wire Secondary
 1 - Shift Street Light

See WR# 1080127

Note: Wire Work in this WR Includes Removal of Old Primary Within WR's 1080127, 1080139 & 1080256 Also

Point 30
11436

- INST --
 1 - Sup CBL Spacer
 1 - Pole Top Pin 24 in.
 1 - Secondary Clamp
 1 - Dbl 10ft Crossarms & 7 ft AlleyArm Brace
 5 - High Voltage Insulator and F Neck Tie
 1 - Transformer Cluster Mount
 3 - Transformer CLF - Material Only
 1 - Driven Ground

- REMOV --
 1 - Remove Pole Framing

- TRAN --
 3 - Shift Line or Equipment Tap
 3 - Reconnect Service Taps
 1 - Shift Open Wire Secondary
 3 - Shift Transformer
 3 - Temporarily Shift Live Pri/Sec

Point 40
785

- INST --
 1 - Secondary Clamp
 1 - Pole Top Pin 24 in.
 1 - Dbl 10ft Crossarms & 7 ft AlleyArm Brace
 5 - High Voltage Insulator and F Neck Tie

- REMOV --
 1 - Pole Top Pin 24 in.
 1 - Single 8 Ft Crossarm
 1 - 3-Spool Secondary Rack
 3 - High Voltage Insulator and F Neck Tie

- TRAN --
 3 - Temporarily Shift Live Pri/Sec
 1 - Shift Open Wire Secondary
 1 - Shift Street Light
 2 - Shift Service

Point 20
786

- INST --
 8 - BREAK CONCRETE - LABOR HOURS
 1 - Sup CBL Spacer
 1 - Pole Wood 45 FT CL2 UI Joint
 1 - Guy Ins 104IN and Mtng Plate
 1 - Pole Guy 10M
 1 - Single 8 Ft Crossarm
 1 - Pole Top Pin 24 in.
 3 - High Voltage Insulator and F Neck Tie
 1 - Transformer CLF - Material Only
 1 - Driven Ground

- REMOV --
 1 - Remove Pole Framing - Cut Pole Top

- TRAN --
 1 - Shift Line or Equipment Tap
 1 - Shift Transformer
 3 - Temporarily Shift Live Pri/Sec
 1 - Shift Street Light
 1 - Shift Open Wire Secondary

252Y Conversion Project				WAGNER TECHNICAL SERVICES INC	
Task: Prep for Hallett 252Y Conversion – Make Ready			Work Request: 1080126		
Street: East Main St.		X Street: Crescent Pl.			
Town: Bridgeport	Substation: Hallett		Circuit: 252Y		
Date: 12-5-2008	Revision:	Tile: E15J1	Page: 1 of 1		