

- Call Before You Dig
- Wait The Required Time
- Confirm Utility Response
- Respect The Marks
- Dig With Care

Call 811 before you Dig
16 NYCRR - PART 753

* = Measurement from edge of white line to the pole. Edge of road/curb is used where there is no white line

	EXISTING POLE		REMOVE TRANSFORMER		1 PH RISER		AREA LIGHT		CAPACITOR BANK
	REPLACE POLE		TRANSFORMER SIZE/PHASE		3 PH RISER		STREET LIGHT		CIRCUIT TIE
	NEW POLE		1 PH SPUR FUSED		FUSED CUTOUT		SINGLE PHASE RECLOSERS WITH BYPASS FUSES		CLOSED 3 PH LOAD BREAK SWITCH
	REMOVE POLE		2 PH SPUR FUSED		SOLID BLADE CUTOUT		OPEN 600 AMP SWITCH		OPEN 3 PH LOAD BREAK SWITCH
	GUY & ANCHOR		3 PH SPUR FUSED		REGULATOR		CLOSED 600 AMP SWITCH		OPEN SEC
	GUY								



DATE	7/14/10
As-built Date	5/16/2012
LOG NO.	
DIVISION	POU
REV	
SHEET	1 OF 6

Dig Safely.

- Call Before You Dig
- Wait The Required Time
- Confirm Utility Response
- Respect The Marks
- Dig With Care

Call 811 before you Dig
16 NYCRR - PART 753

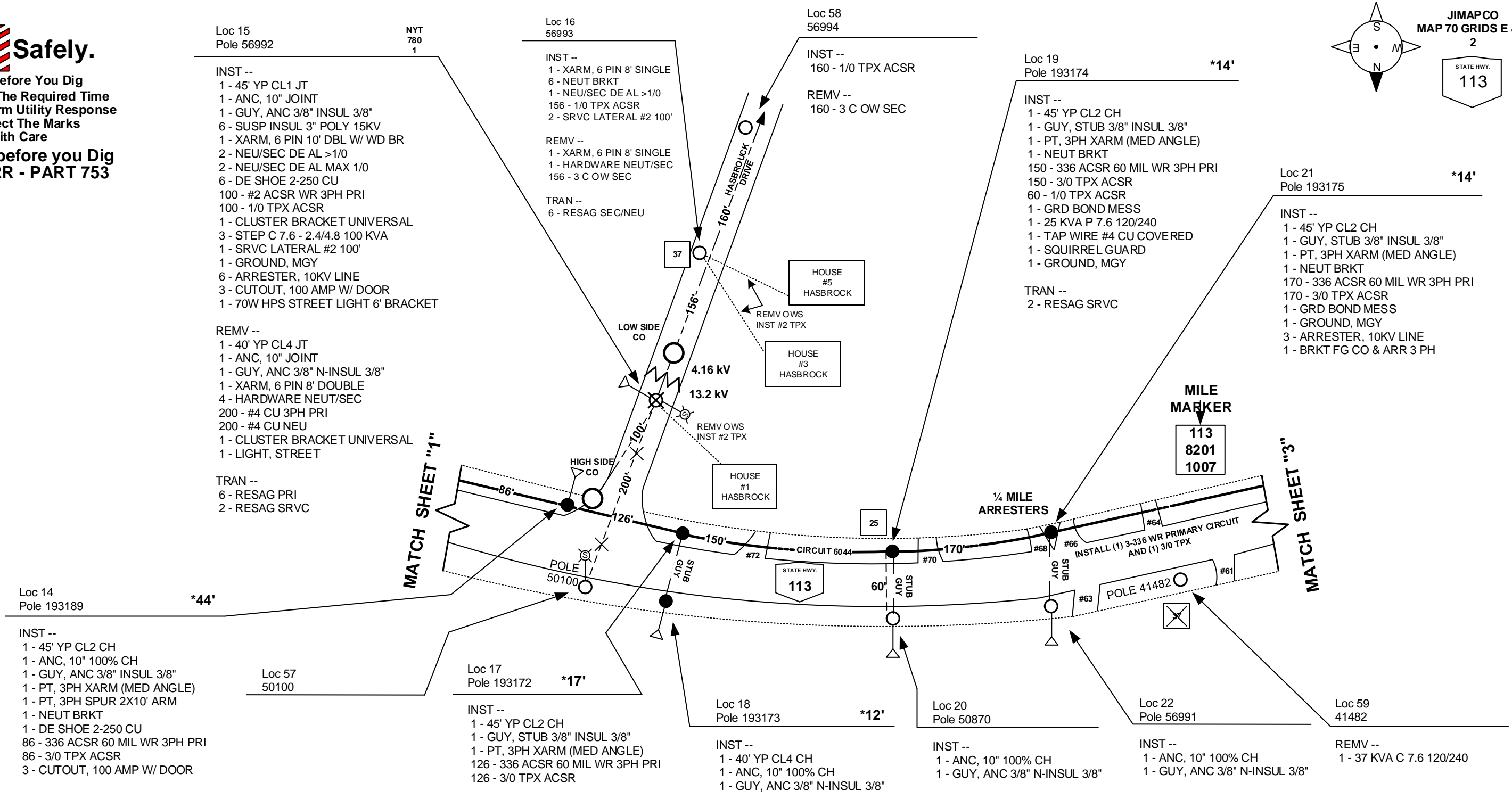
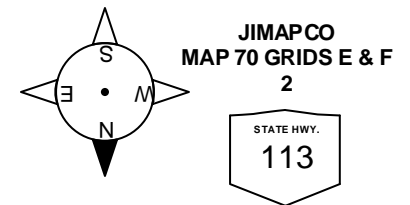

Loc 15 Pole 56992
 INST --
 1 - 45' YP CL1 JT
 1 - ANC, 10" JOINT
 1 - GUY, ANC 3/8" INSUL 3/8"
 6 - SUSP INSUL 3" POLY 15KV
 1 - XARM, 6 PIN 10' DBL W/ WD BR
 2 - NEU/SEC DE AL >1/0
 2 - NEU/SEC DE AL MAX 1/0
 6 - DE SHOE 2-250 CU
 100 - #2 ACSR WR 3PH PRI
 100 - 1/0 TPX ACSR
 1 - CLUSTER BRACKET UNIVERSAL
 3 - STEP C 7.6 - 2.4/4.8 100 KVA
 1 - SRVC LATERAL #2 100'
 1 - GROUND, MGY
 6 - ARRESTER, 10KV LINE
 3 - CUTOUT, 100 AMP W/ DOOR
 1 - 70W HPS STREET LIGHT 6' BRACKET

REMV --
 1 - 40' YP CL4 JT
 1 - ANC, 10" JOINT
 1 - GUY, ANC 3/8" N-INSUL 3/8"
 1 - XARM, 6 PIN 8' DOUBLE
 4 - HARDWARE NEUT/SEC
 200 - #4 CU 3PH PRI
 200 - #4 CU NEU
 1 - CLUSTER BRACKET UNIVERSAL
 1 - LIGHT, STREET

TRAN --
 6 - RESAG PRI
 2 - RESAG SRVC

Loc 16 56993
 INST --
 1 - XARM, 6 PIN 8' SINGLE
 6 - NEUT BRKT
 1 - NEU/SEC DE AL >1/0
 156 - 1/0 TPX ACSR
 2 - SRVC LATERAL #2 100'

REMV --
 1 - XARM, 6 PIN 8' SINGLE
 1 - HARDWARE NEUT/SEC
 156 - 3 C OW SEC

TRAN --
 6 - RESAG SEC/NEU

Loc 58 56994
 INST --
 160 - 1/0 TPX ACSR

REMV --
 160 - 3 C OW SEC

Loc 19 Pole 193174 *14'
 INST --
 1 - 45' YP CL2 CH
 1 - GUY, STUB 3/8" INSUL 3/8"
 1 - PT, 3PH XARM (MED ANGLE)
 1 - NEUT BRKT
 150 - 336 ACSR 60 MIL WR 3PH PRI
 150 - 3/0 TPX ACSR
 60 - 1/0 TPX ACSR
 1 - GRD BOND MESS
 1 - 25 KVA P 7.6 120/240
 1 - TAP WIRE #4 CU COVERED
 1 - SQUIRREL GUARD
 1 - GROUND, MGY

TRAN --
 2 - RESAG SRVC

Loc 21 Pole 193175 *14'
 INST --
 1 - 45' YP CL2 CH
 1 - GUY, STUB 3/8" INSUL 3/8"
 1 - PT, 3PH XARM (MED ANGLE)
 1 - NEUT BRKT
 170 - 336 ACSR 60 MIL WR 3PH PRI
 170 - 3/0 TPX ACSR
 1 - GRD BOND MESS
 1 - GROUND, MGY
 3 - ARRESTER, 10KV LINE
 1 - BRKT FG CO & ARR 3 PH

Loc 14 Pole 193189 *44'
 INST --
 1 - 45' YP CL2 CH
 1 - ANC, 10" 100% CH
 1 - GUY, ANC 3/8" INSUL 3/8"
 1 - PT, 3PH XARM (MED ANGLE)
 1 - PT, 3PH SPUR 2X10' ARM
 1 - NEUT BRKT
 1 - DE SHOE 2-250 CU
 86 - 336 ACSR 60 MIL WR 3PH PRI
 86 - 3/0 TPX ACSR
 3 - CUTOUT, 100 AMP W/ DOOR

Loc 57 50100

Loc 17 Pole 193172 *17'
 INST --
 1 - 45' YP CL2 CH
 1 - GUY, STUB 3/8" INSUL 3/8"
 1 - PT, 3PH XARM (MED ANGLE)
 126 - 336 ACSR 60 MIL WR 3PH PRI
 126 - 3/0 TPX ACSR

Loc 18 Pole 193173 *12'
 INST --
 1 - 40' YP CL4 CH
 1 - ANC, 10" 100% CH
 1 - GUY, ANC 3/8" N-INSUL 3/8"

Loc 20 Pole 50870
 INST --
 1 - ANC, 10" 100% CH
 1 - GUY, ANC 3/8" N-INSUL 3/8"

Loc 22 Pole 56991
 INST --
 1 - ANC, 10" 100% CH
 1 - GUY, ANC 3/8" N-INSUL 3/8"

Loc 59 41482
 REMV --
 1 - 37 KVA C 7.6 120/240

* = Measurement from edge of white line to the pole. Edge of road/curb is used where there is no white line

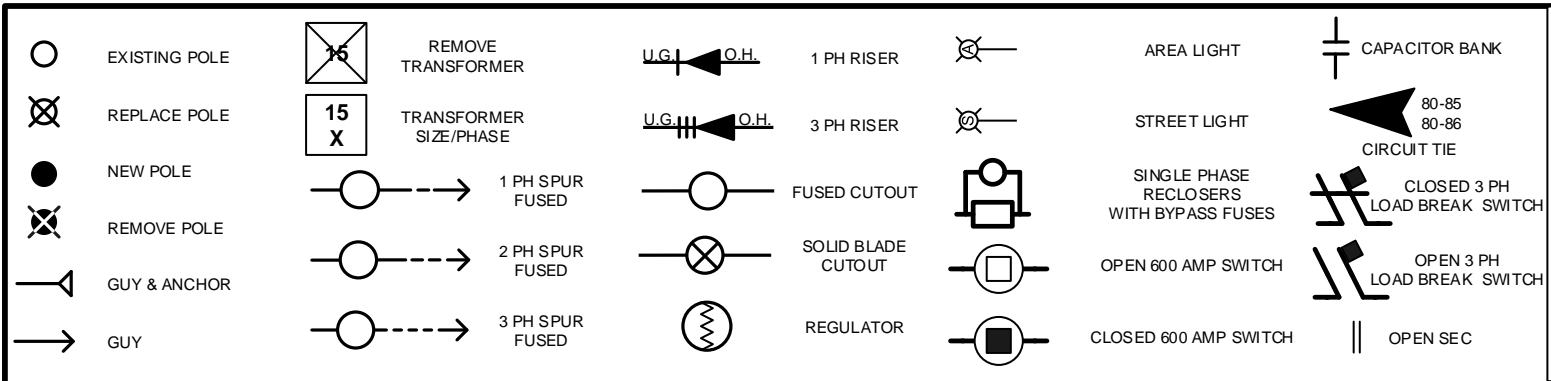

DATE	7/14/10
As-built Date	5/16/2012
LOG NO.	
DIVISION	POU
REV	
SHEET	2 OF 6

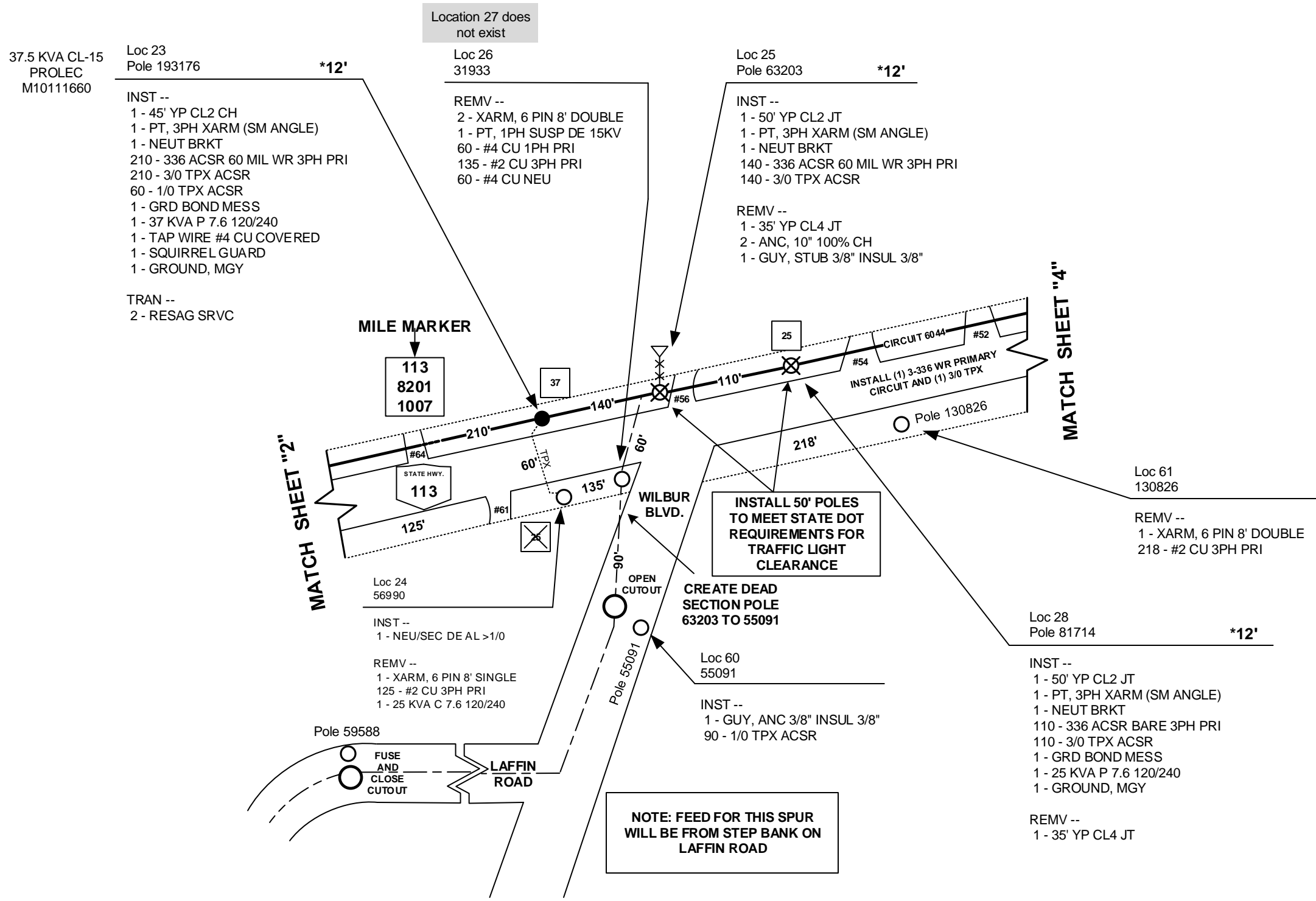

Dig Safely.

- Call Before You Dig
- Wait The Required Time
- Confirm Utility Response
- Respect The Marks
- Dig With Care

Call 811 before you Dig
16 NYCRR - PART 753

* = Measurement from edge of white line to the pole. Edge of road/curb is used where there is no white line

	EXISTING POLE		REMOVE TRANSFORMER		1 PH RISER		AREA LIGHT		CAPACITOR BANK
	REPLACE POLE		TRANSFORMER SIZE/PHASE		3 PH RISER		STREET LIGHT		80-85 80-86 CIRCUIT TIE
	NEW POLE		1 PH SPUR FUSED		FUSED CUTOUT		SINGLE PHASE RECLOSERS WITH BYPASS FUSES		CLOSED 3 PH LOAD BREAK SWITCH
	REMOVE POLE		2 PH SPUR FUSED		SOLID BLADE CUTOUT		OPEN 600 AMP SWITCH		OPEN 3 PH LOAD BREAK SWITCH
	GUY & ANCHOR		3 PH SPUR FUSED		REGULATOR		CLOSED 600 AMP SWITCH		OPEN SEC
	GUY								

DATE	7/14/10
As-built Date	5/16/2012
LOG NO.	
DIVISION	POU
REV	
SHEET	3 OF 6

OAKWOOD FRIENDS
SCHOOL

Loc 39
CP 87279

Loc 38
Pole 193191

Loc 41
Pole 193182

Loc 42
Pole 193183

Loc 47
Pole 193184

INST --
1 - 45' YP CL2 CH
1 - PB 45' YP CL4 CH
1 - PUSH BRACE BRKT
1 - PT, 3PH XARM (MED ANGLE)
1 - NEUT BRKT
185 - 336 ACSR 60 MIL WR 3PH PRI
185 - 3/0 TPX ACSR

INST --
1 - 45' YP CL2 CH
1 - ANC, 10" 100% CH
1 - GUY, ANC 3/8" N-INSUL 3/8"
1 - PT, 3PH XARM (SM ANGLE)
1 - NEUT BRKT
195 - 336 ACSR 60 MIL WR 3PH PRI
195 - 3/0 TPX ACSR
1 - 25 KVA P 7.6 120/240
1 - TAP WIRE #4 CU COVERED
1 - SQUIRREL GUARD
1 - GROUND, MGY

INST --
1 - 45' YP CL2 CH
1 - PT, 3PH XARM (SM ANGLE)
1 - NEUT BRKT
185 - 336 ACSR 60 MIL WR 3PH PRI
185 - 3/0 TPX ACSR

INST --
1 - 45' YP CL2 CH
6 - SUSP INSUL 3" POLY 15KV
1 - PT, 3PH DDE 2X8' ARMS
6 - DE SHOE 2-250 CU
1 - CLUSTER BRACKET UNIVERSAL
3 - STEP C 7.6 - 2.4/4.8 50 KVA
1 - GROUND, MGY
3 - ARRESTER, 10KV LINE
3 - CUTOUT, 100 AMP W/ DOOR

TRAN --
3 - RESAG PRI
1 - RESAG SEC/NEU

Loc 37
Pole 193181

INST --
1 - 45' YP CL2 CH
1 - PT, 3PH XARM (SM ANGLE)
1 - PT, 3PH DE OR SPUR 2X8' ARM
1 - NEUT BRKT
1 - NEU/SEC DE AL >1/0
155 - 336 ACSR 60 MIL WR 3PH PRI
155 - 3/0 TPX ACSR
1 - GROUND, MGY
3 - ARRESTER, 10KV LINE
3 - CUTOUT, 100 AMP W/ DOOR

TRAN --
3 - RESAG PRI
1 - RESAG SEC/NEU

#4 CU 3ph primary & #4 CU neut. was removed from P24234 and a portion of it was reused between 193181, 193191 & CP87279
Accounting note:

MATCH SHEET "4"

MATCH SHEET "6"

Loc 40
Pole 24234

REMV --
1 - XARM, 6 PIN 8' DOUBLE
1 - HARDWARE NEUT/SEC
147 - #4 CU 3PH PRI
147 - #4 CU NEU
3 - CUTOUT, 100 AMP W/ DOOR

Loc 43
16829

INST --
129 - 3/0 TPX ACSR

REMV --
129 - 3 C OW SEC
3 - 25 KVA P 2.4 X 7.6 120/240
3 - CUTOUT, 100 AMP W/ DOOR
1 - RISER, 4"

Loc 44
16828

INST --
1 - XARM, 6 PIN 10' DBL W/ WD BR
1 - PT, 3PH DDE 2X8' ARMS
2 - NEU/SEC DE AL >1/0
100 - 3/0 ACSR BARE
141 - 1/0 TPX ACSR

REMV --
1 - XARM, 6 PIN 8' DOUBLE
2 - HARDWARE NEUT/SEC
100 - 3 C OW SEC
3 - CUTOUT, 100 AMP W/ DOOR

TRAN --
6 - RESAG PRI
2 - RESAG SEC/NEU

Loc 46
16827

REMV --
70 - CBL PRI EPR, 4/0 UG 3-1/C CU PAR 15 KV
1 - XARM, 6 PIN 8' DOUBLE
3 - ARRESTER, 5 KV RISER
3 - CUTOUT, 100 AMP W/ DOOR
210 - CBL, PRI UG 1 PH #2 AL 2C 15KV
2 - RISER, 4"

Loc 45
PAD 609422

Pad no longer exists.
Accounting note:

REMV --
3 - XFMR, 225 KVA PDMT 3PH P 7.6 208/120V
1 - PAD COVER, BLANK F/ FG XFMR PAD

Installed new Pad mount to feed the school. See J586516

MARTHA W LAWRENCE
SCHOOL

* = Measurement from edge of white line to the pole. Edge of road/curb is used where there is no white line

Dig Safely.

- Call Before You Dig
- Wait The Required Time
- Confirm Utility Response
- Respect The Marks
- Dig With Care

Call 811 before you Dig
16 NYCRR - PART 753

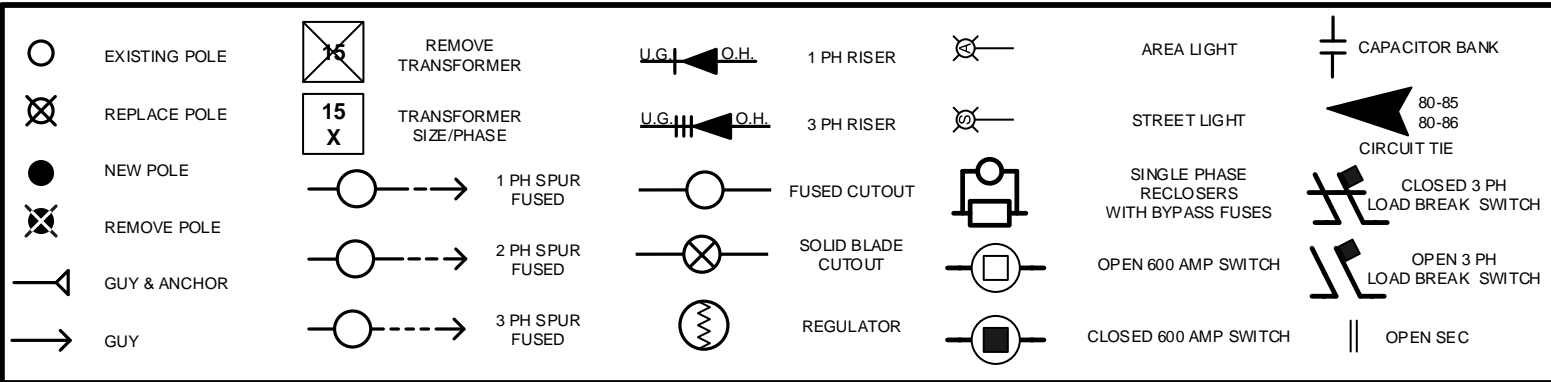

DATE	7/14/10
As-built Date	5/16/2012
LOG NO.	
DIVISION	POU
REV	
SHEET	5 OF 6

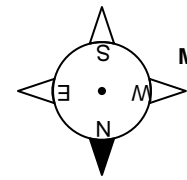

Locations 57,58 & 59 on sheet 2
Locations 60 & 61 on sheet 3
Locations 62 - 65 on sheet 4
Accounting note:

Loc 48
Pole 193185
INST --
1 - 45' YP CL2 CH
3 - ANC, 10" 100% CH
3 - GUY, ANC 3/8" INSUL 3/8"
2 - PT, 3PH DDE 2X8' ARMS
6 - DE SHOE 4-336 AL
185 - 336 ACSR 60 MIL WR 3PH PRI
185 - 3/0 TPX ACSR

Loc 49
Pole 193186
INST --
1 - 45' YP CL2 CH
2 - ANC, 10" 100% CH
2 - GUY, ANC 3/8" INSUL 3/8"
1 - PT, 3PH XARM (MED ANGLE)
1 - NEUT BRKT
145 - 336 ACSR 60 MIL WR 3PH PRI
145 - 3/0 TPX ACSR
120 - 1/0 TPX ACSR
1 - 25 KVA P 7.6 120/240

Loc 56
0120002
REMV --
120 - CBL, UG PRI 3PH 500 MCM CU 15KV
120 - CBL, UG 1/0 CU 600V

Foreman's Note:
Found 600 amp tees stacked in manhole.
Disassembled and removed conductor
from stack to substation

Loc 50
Pole 193187
INST --
1 - 45' YP CL2 CH
1 - XARM, 6 PIN 8' DOUBLE
1 - NEUT BRKT
150 - 336 ACSR 60 MIL WR 3PH PRI
150 - 3/0 TPX ACSR
3 - SWITCH, 600A DISCONNECT 1PH 15KV

Loc 55
Pole 16826
INST --
96 - 3/0 TPX ACSR
REMV --
96 - 3 C OW SEC

Loc 54
Pole 16825
INST --
1 - SEC (TPX/QPX) BRKT
161 - 3/0 TPX ACSR
1 - SRVC LATERAL #2 100'
REMV --
3 - HARDWARE NEUT/SEC
161 - 3 C OW SEC

Loc 53
Pole 16824
INST --
1 - SEC (TPX/QPX) BRKT
213 - 3/0 TPX ACSR
1 - SRVC LATERAL #2 50'
REMV --
3 - HARDWARE NEUT/SEC
213 - 3 C OW SEC

Loc 52
Pole 16823
INST --
1 - NEU/SEC DE AL >1/0

Loc 51
Pole 55811
INST --
3 - DE SHOE 4-336 AL
151 - 336 ACSR 60 MIL WR 3PH PRI
151 - 3/0 TPX ACSR

MATCH SHEET "5"

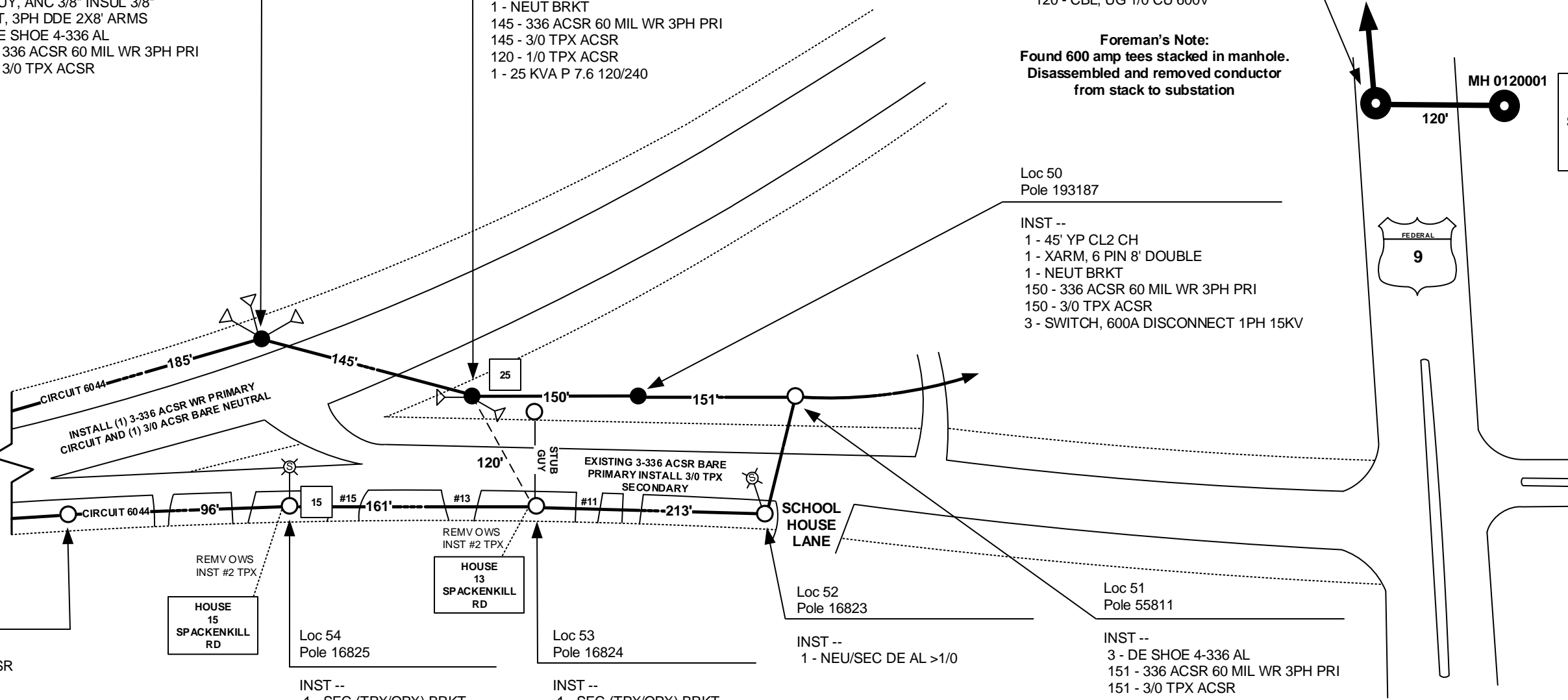

ORIGINAL
SPACKENKILL
SUBSTATION



Dig Safely.

- Call Before You Dig
- Wait The Required Time
- Confirm Utility Response
- Respect The Marks
- Dig With Care

Call 811 before you Dig
16 NYCRR - PART 753

* = Measurement from edge of white line to the pole. Edge of road/curb is used where there is no white line

	EXISTING POLE		REMOVE TRANSFORMER		1 PH RISER		AREA LIGHT		CAPACITOR BANK
	REPLACE POLE		TRANSFORMER SIZE/PHASE		3 PH RISER		STREET LIGHT		80-85 80-86 CIRCUIT TIE
	NEW POLE		1 PH SPUR FUSED		FUSED CUTOUT		SINGLE PHASE RECLOSERS WITH BYPASS FUSES		CLOSED 3 PH LOAD BREAK SWITCH
	REMOVE POLE		2 PH SPUR FUSED		SOLID BLADE CUTOUT		OPEN 600 AMP SWITCH		OPEN 3 PH LOAD BREAK SWITCH
	GUY & ANCHOR		3 PH SPUR FUSED		REGULATOR		CLOSED 600 AMP SWITCH		OPEN SEC
	GUY								



DATE	7/14/10
As-built Date	5/16/2012
LOG NO.	
DIVISION	POU
REV	
SHEET	6 OF 6